

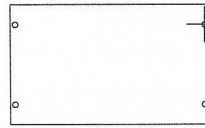

VE Series

EEMAC / NEMA I Ventilated Enclosures

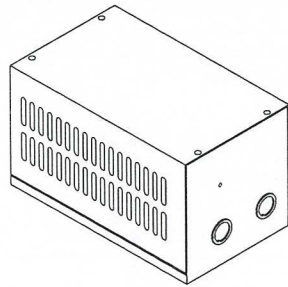

0.281 DIA. (x4) FOR
10-32 SCREWS

Cover Top View

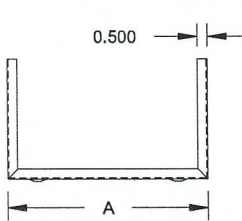

Front View

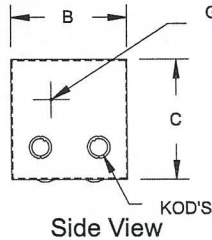

Side View

GROUND
HOLE

KOD'S

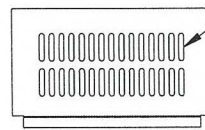

Cover Front View

VENT OPENINGS

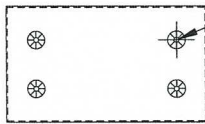

Bottom View

0.250 DIA.
EMBOSSD
MOUNTING
HOLES (x4)

TECHNICAL READOUT

Catalog No.	Dimensions		
	A	B	C
VE100603	10.000	6.000	3.000
VE100606	10.000	6.000	6.000
VE120808	12.000	8.000	8.000
VE151008	15.000	10.000	8.000
VE151010	15.000	10.000	10.000
VE151314	15.250	13.250	14.250
VE181617	18.250	16.250	17.250
VE181812	18.000	18.000	12.000
VE201010	20.000	10.000	10.000
VE202020	20.250	20.250	20.250
VE222215	22.000	22.000	15.000
VE253030	25.000	30.000	30.000
VE441010	44.000	10.000	10.000

Application:

Enclosures, used as general purpose whenever the contents requires ventilation.

Construction:

- Box and cover are made from 16 GA steel
- Two knockouts on the smaller sides
- Larger sides are fully vented
- Ventilated cover, fixed by four screws
- Four embossed mounting holes
- Grounding hole
- ANSI/ASA61 grey polyester textured powder coating inside out.

Also Available:

- Special finishes & sizes

