

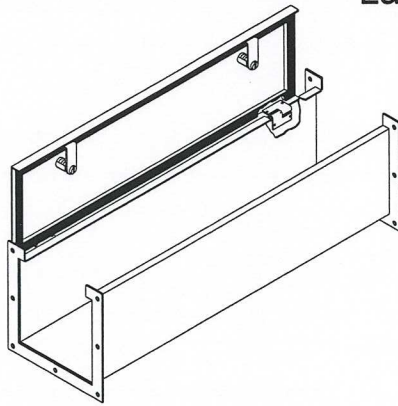

BB..LD Series

EEMAC / NEMA 12 Oil and Dust Tight Lay-In Wireway



TECHNICAL READOUT

Description	2.5" x 2.5" Catalog No.	Weight lbs.	4" x 4" Catalog No.	Weight lbs.	6" x 6" Catalog No.	Weight lbs.	Sealing Plate (Qty.)
12" Wireway Section	BB21LD	3.5	BB41LD	5	BB61LD	7.5	1 Flat
24" Wireway Section	BB22LD	6.25	BB42LD	10	BB62LD	14	1 Flat
36" Wireway Section	BB23LD	9.25	BB43LD	13.75	BB63LD	20.75	1 Flat
48" Wireway Section	BB24LD	12	BB44LD	19.25	BB64LD	28	1 Flat
60" Wireway Section	BB25LD	29.25	BB45LD	23.75	BB65LD	34.5	1 Flat
120" Wireway Section	BB210LD	29.25	BB410LD	46.75	BB610LD	68.25	1 Flat
Accessories							
90° Elbow Top Opening	BB290ET	1.25	BB490ET	2.75	BB690ET	5	1 Flat
90° Elbow Inside Opening	BB290EI	2.25	BB490EI	2.75	BB690EI	5	1 Flat
90° Elbow Outside Opening	BB290EO	2.25	BB490EO	2.75	BB690EO	5	1 Flat
45° Elbow Top Opening	BB245ET	2.25	BB445ET	2.25	BB645ET	3.5	1 Flat
45° Elbow Inside Opening	BB245EI	2.25	BB445EI	2.25	BB645EI	7.5	1 Flat
45° Elbow Outside Opening	BB245EO	2.25	BB445EO	2.25	BB645EO	3.5	1 Flat
Tee Fitting Top Opening	BB2TT	2.75	BB4TT	3.25	BB6TT	6	2 Flat
Tee Fitting Outside Opening	BB2TO	2.75	BB4TO	3.25	BB6TO	6	2 Flat
Closing Plate	BB2CP	0.25	BB4CP	0.5	BB6CP	1	1 Angle
Box Connector	BB2AD	0.25	BB4AD	0.25	BB6AD	0.5	1 Angle
Reducer			BB42R	2	BB64R	3	-
1" Nipple	BB2N1	0.75	BB4N1	1	BB6N1	1.5	1 Flat
2" Nipple	BB2N2	1	BB4N2	1.25	BB6N2	2	1 Flat
3" Nipple	BB2N3	1.25	BB4N3	1.75	BB6N3	2.75	1 Flat
Swivel Nipple Box Entry (not shown)	BB2SWL1	1	BB4SWL1	1.50	BB6SWL1	2	1 Angle
Swivel Nipple Regular (not shown)	BB2SWL2	1.25	BB4SWL2	1.75	BB6SWL2	2.75	2 Angle
Hanger	BB2H	0.75	BB4H	1	BB6H	1.25	-
Bracket Hanger	BB2HM	1.5	BB4HM	1.75	BB6HM	2	-
Flat Sealing Plate (not shown)	BB2FSP	0.25	BB4FSP	0.25	BB6FSP	0.5	-
Angle Sealing Plate (not shown)	BB2ASP	0.25	BB4ASP	0.25	BB6ASP	0.5	-
Cut-Off Fitting (lay-in)	BB2COF	4.25	BB4COF	6.25	BB6COF	9.25	1 Flat
Adjustable Fitting	BB2AF	2.5	BB4AF	3.5	BB6AF	5.75	1 Spec.
Junction Box	BB2JB	9.5	BB4JB	14.25	BB6JB	19.5	1 Flat
Cross Fitting Top Opening	BB2CFT	3	BB4CFT	5.5	BB6CFT	6.5	3 Flat
12" Clockwise transposition Section	BB2CC	3.5	BB4CC	5.25	BB6CC	7.75	1 Flat
12" Counter-Clock Transposition Section	BB2CRC	3.5	BB4CRC	5.25	BB6CRC	7.75	1 Flat

Application:

Type 12 enclosure designed for indoor use to protect electrical wiring against dust, dirt and oil.

Construction:

- 16 steel gauge
- Continuously welded and ground smooth seams
- Easy to install gasketed sealing plates
- 12 gauge interconnecting flanges (2 per length)
- 1/4 turn latches
- ANSI/ASA61 grey polyester textured powder coating inside out

Also Available:

- Aluminium, SS, galvanized steel
- Cutouts, holes, hubs,
- Special finishes sizes



BB..LD Series

EEMAC / NEMA 12 Oil and Dust Tight Lay-In Wireway

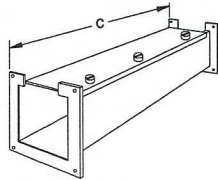

Straight Section

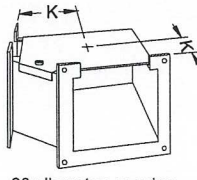

90 elbow top opening

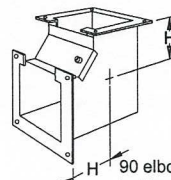

90 elbow inside opening

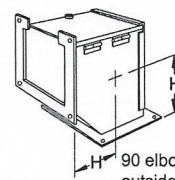

90 elbow outside opening

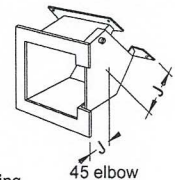

45 elbow top opening

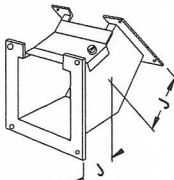

45 elbow inside opening

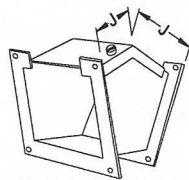

45 elbow outside opening

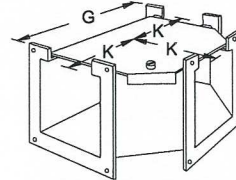

Tee fitting top opening

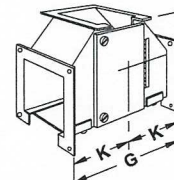

Tee fitting outside opening

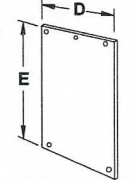

Closing plate

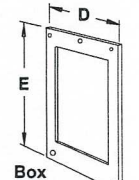

Box Connector

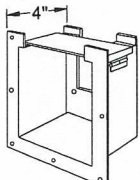

Reducer

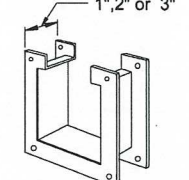

Nipple

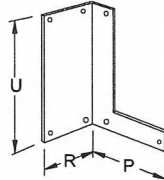

Bracker Hanger

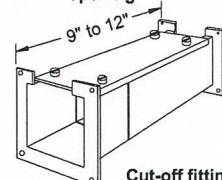

Cut-off fitting (lay-in)

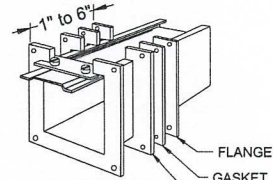

Adjustable fitting

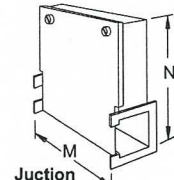

Junction Box

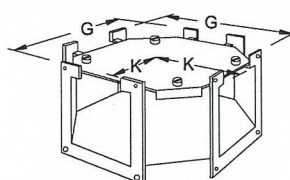

Cross fitting top opening

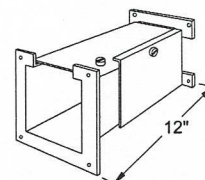

12" transposition clockwise

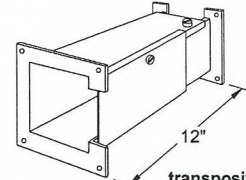

transposition counter-clockwise

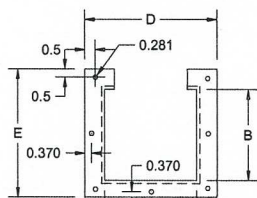

6"x6" model

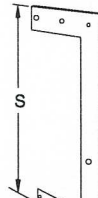

Drop hanger

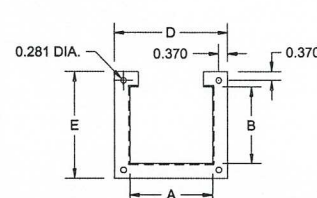

2-1/2" x 2-1/2" & 4" x 4" MODEL

DUCT SIZE

A	B	C	D	E	G	H	J	K	M	N	P	R	S	T	U
2.500 x 2.500		12,24,36,48,60,120	3.875	3.875	8.500	4.25	2.275	4.25	12.000	10.25	4.625	3.597	9.25	4.500	4.375
4.000 x 4.000		12,24,36,48,60,120	5.375	5.375	10.000	5.000	2.586	5.000	14.000	13.875	6.125	3.597	11.75	6.000	5.875
6.000 x 6.000		12,24,36,48,60,120	7.625	7.625	12.000	6.000	3.000	6.000	16.000	17.875	8.25	3.597	15.25	8.125	7.875